

# WINDOW INSTALLATION METHOD A1



Mounting Flange Window installed in a Membrane/Drainage System

## Window installation based on Method "A1" requires:

- The water resistive barrier to be applied first, before the window is installed
- The jamb and head flashing to be installed over the mounting flange after the window is installed

## INSTALLATION GUIDE:

### MODIFY THE WRB (STEP 1)

- When the WRB covers the window opening, make a modified "I-cut" in the barrier (Figure 1)
- Fold bottom and side flaps over and behind the interior sides of the rough framing (Figure 2)
- Fasten flaps on interior every 12-16" or per WRB Manufacturer's recommendations
- Measure for diagonal cuts at top of window corners for both building paper and house wrap (Figure 3)
- Measure from the corner the width of the flashing up and over and mark 45° diagonal (Figure 3.1)
- Cut on the diagonal from marked point to the rough opening corner
- Measure and cut the other upper corner
- Gently raise top edge of WRB and tape the corners to the surface barrier above

### INSTALL THE SILL FLASHING (STEP 2)

- Cut flashing material to correct length (Figure 4)
- Apply the horizontal sill flashing level with top edge of rough opening frame
- Each end of the sill flashing should extend approximately the width of flashing membrane beyond the rough opening at the jamb condition
- Apply Sill Pan where required by building code or in high wind and water regions
- If the building's exterior cladding will not be applied immediately, apply tape at the corners and edges of flashing to prevent wind damage
- In order to avoid trapping water behind flashing, never apply the tape continuously

Figure 1: Modified WRB

WRB CUT IN A MODIFIED "I" PATTERN

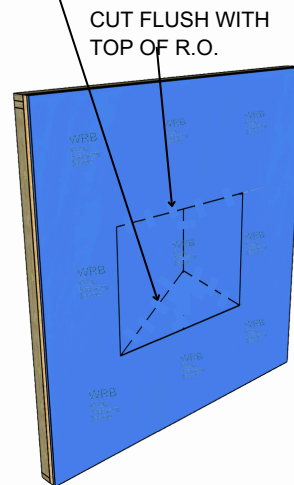

Figure 2: Fasten WRB

CUT WRB AND FOLD TO INTERIOR. ATTACHED AND TRIM AS REQUIRED AT SILL AND JAMBS

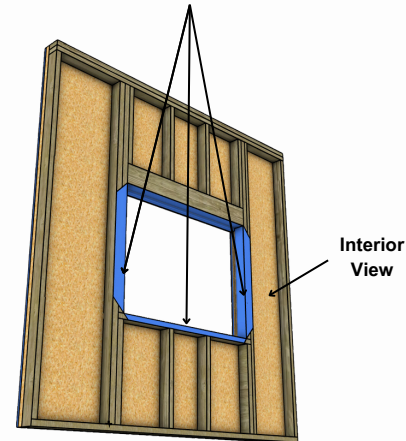

Figure 3: Cut Flap at Head and Tape

CUT FLAP AT HEAD AND TAPE

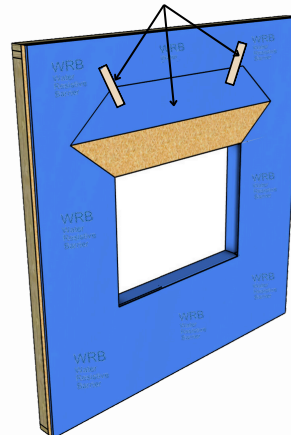

Figure 3.1

CUT TOP PORTION TO CREATE FLAP. THEN RAISE AND TAPE TEMPORARILY TO HEAD CONDITION

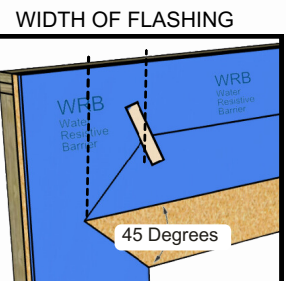
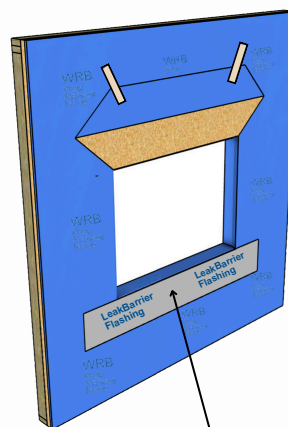

Figure 4: Install Sill Flashing



### INSTALLATION GUIDELINES AND LIMITATIONS

- INSTALLATION "METHOD A1" REFERS TO COMMON WINDOWS (SURFACE MOUNTED).
- INSTALL WINDOW PER WINDOW MANUFACTURER REQUIREMENTS.
- SEE PRODUCT SPECIFIC TECHNICAL DATA SHEET FOR ROLL SIZES, MAXIMUM UV EXPOSURE, COMPATIBILITY CONCERNS, APPLICATION TEMPERATURES AND SERVICE TEMPERATURE LIMITATIONS.
- FLASHINGS MAY NOT BE COMPATIBLE WITH ALL MATERIALS AND SEALANTS. VERIFY ALL MATERIAL COMPATIBILITY AND VERIFY SEALANT COMPATIBILITY AS DIRECTED IN AAMA 713.
- HAND ROLL WITH FIRM PRESSURE SELF-ADHERED FLASHING MEMBRANES TO OBTAIN CONTINUOUS ADHESION.
- SUBSTRATES MUST BE CLEAN AND DRY.
- VERIFY WATER-RESISTIVE BARRIER AND FLASHING MEMBRANES ARE FREE FROM PROTRUSIONS OR DAMAGE PRIOR TO EXTERIOR CLADDING INSTALLATION.
- CONTACT TARCO AT 800-365-4506 FOR TECHNICAL ASSISTANCE.

## WINDOW INSTALLATION

### (STEP 3)

- Install window per Window Manufacturer requirements (Figure 5)
- Flashings may not be compatible with all sealants, use sealants as indicated or verify compatibility as directed in AAMA 713
- Apply a continuous 3/8" bead of sealant on interior side of window flange

## INSTALL JAMB FLASHING

### (STEP 4)

- Install jamb flashing on the left and right sides of the rough opening over the flange (Figure 6)
- Terminate jamb flashing approximately 1/2" beneath the top horizontal outside edge of the head flashing. Terminate jamb flashing 1/2" above the bottom horizontal outside edge of the sill flashing

## HEAD FLASHING

### (STEP 5)

- Apply window flashing over window head flange (Figure 7)
- Extend head flashing at least 1" (25MM) beyond the outside edge of the jamb flashing on both sides

## SECURE WRB AT THE HEAD

### (STEP 6)

- Tuck head flashing under the flap of the WRB at the head (Figure 8)
- Remove previously applied tape which holds flap of WRB at the head
- Allow the flap to lie flat over the head flashing
- Apply a new piece of sheathing tape over the entire diagonal cut made in the WRB
- Compress the tape against the WRB and head flashing which extends over the jamb



For more information visit: [www.tarcoroofing.com](http://www.tarcoroofing.com)

Figure 5: Install Window

INSTALL WINDOW PER WINDOW MANUFACTURER REQUIREMENTS

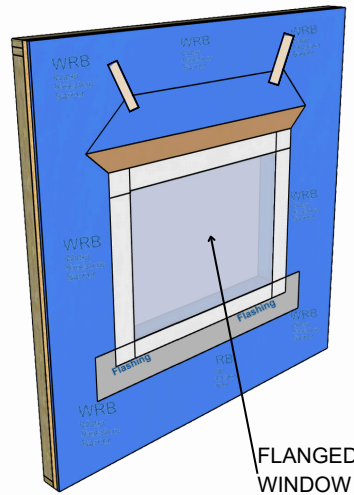

Figure 6: Install Jamb Flashing

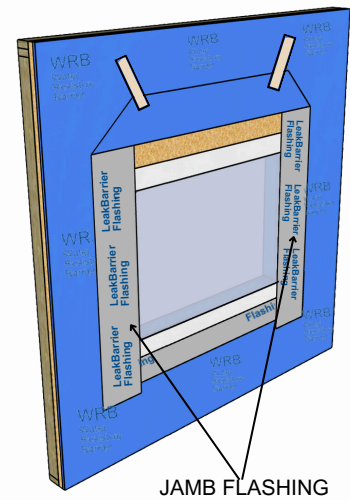

Figure 7: Install Head Flashing

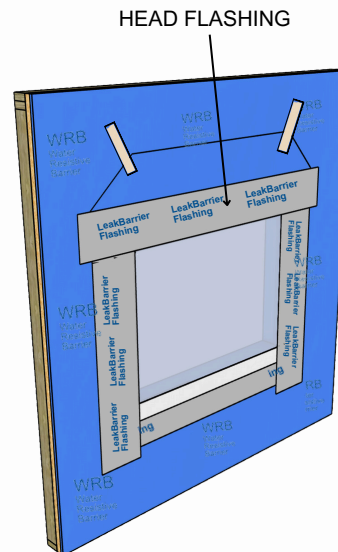
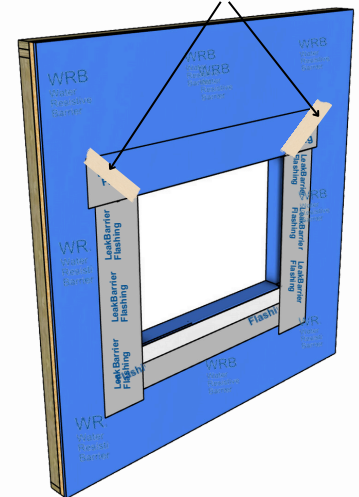

Figure 8: Tape Down WRB at Head

SECURE WRB HEAD FLAP DIAGONAL CUTS



### NOTE:

MANUFACTURER INSTALLATION GUIDELINES ARE FOR REFERENCE ONLY. TARCO DOES NOT ASSUME RESPONSIBILITY FOR ERRORS OR DEVIATIONS IN DESIGN OR ENGINEERING. PROJECT SPECIFIC VERIFICATION IS RECOMMENDED PRIOR TO INSTALLATION. DETAILS ARE NOT TO SCALE. REFER TO PRODUCT SPECIFIC TECHNICAL DATA SHEET FOR PRODUCT INFORMATION, RECOMMENDED AUXILIARY COMPONENTS AND INSTALLATION INSTRUCTIONS.